

Product Features

- 4.3 inch 480 x 272 Pixel 24 Bit Colour TFT with orientation sensor
- Deep-Field Capacitive Touch with 3mm Acrylic Protection Window
- Software Variable LED Backlight with Auto Stand-By Mode
- Supply Voltage 9V-30VDC with 2W Power Consumption
- Program update via USB port or optional SD card access
- RS485 Modbus RTU communication – Master or Slave
- IP65 Protection (without USB socket option)
- XProgOS operating system compatible
- Screened 2 metre cable interface with inline / panel mount connector
- Options: RS422, RS232, NET, CAN and USB Cable Interfaces
- Battery Backed Real Time Clock
- Outer and Interleave Colours: Red, Yellow, Blue, White, Black, Grey
- Rear access to SD card



Registered Design Pending

Designed for industrial, agricultural and warehouse applications.

This stylish but robust Graphic User Interface supports multi touch via bare or gloved finger using our unique dual layer deep field capacitive touch system.

The integrated handle ensures firm support and easy access for hanger storage.

The built-in memory supports 4GB of memory for program, images and fonts plus data logging and process control functionality.

PROVISIONAL

| Product Parameters | Unit | Min | Max | Notes |
|---|-------------------|-------|-------|--|
| Supply Voltage V_A | VDC | 9 | 30 | Power consumption ~2W with LED backlight 100% |
| Supply Voltage V_B (output when using V_A) | VDC | 4.75 | 5.25 | Via USB connector to PC or USB stick via adaptor |
| Real Time Clock Battery (8 year) | VDC | 3V | 3V | CR1216/CR1225 battery holder |
| Operating Temperature | °C | -20 | 70 | |
| Storage Temperature | °C | -30 | 70 | |
| Relative Humidity | % | 20 | 85 | 25°C operation, non-condensing |
| Display Brightness | Cd/m ² | 280 | 350 | |
| Display Contrast | Ratio | 300:1 | 500:1 | |

| Interface Parameters | Unit | Input | | Output | | Notes |
|-------------------------|------|-------|-----|--------|-----|-------------------------|
| | | Min | Max | Min | Max | |
| RS485/422 Interface | VDC | -5 | +5 | -5 | +5 | 50m Terminator Built In |
| CANBUS Interface option | VDC | 0 | 5 | 0 | 5 | 20m |
| RS232 Interface option | VDC | -15 | +15 | -2 | +7 | 5m |
| USB Interface option | VDC | 0 | 5 | 0 | 5 | USB 2.0 |
| Ethernet Interface | Vpp | -5 | +5 | -5 | +5 | |

| Processor | Unit | Value | Notes |
|--------------|--------|-------|-----------------------|
| ARM 926J CPU | MHz | 500 | EMC Class A compliant |
| DDR2 MEMORY | MByte | 128 | Option - 256Mbyte |
| EMMC MEMORY | GByte | 4 | Option - 8GByte |
| EEPROM | kBytes | 4 | Boot memory |

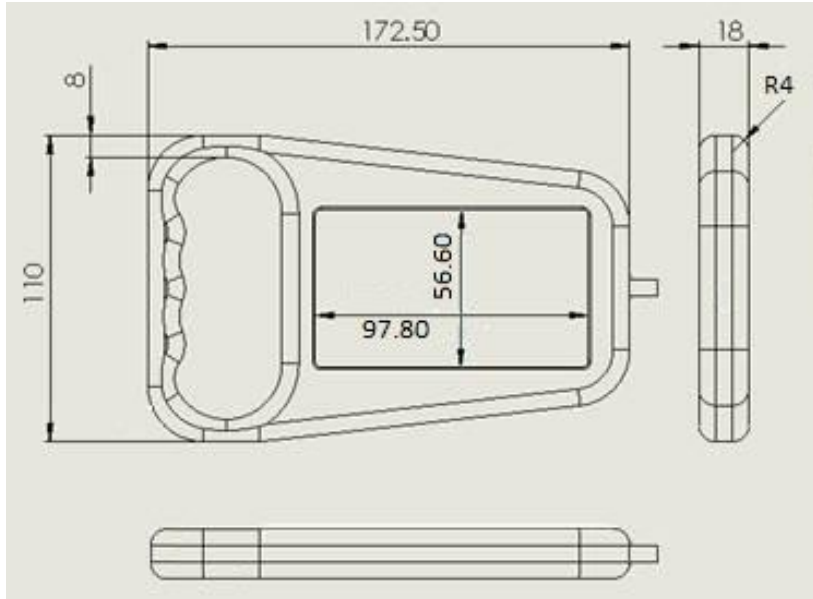

Manual / Auto Rotation



Front View

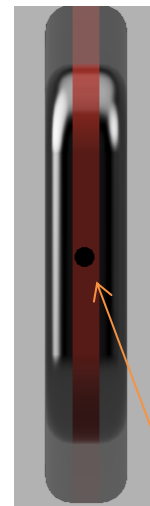

USB Socket

Side View

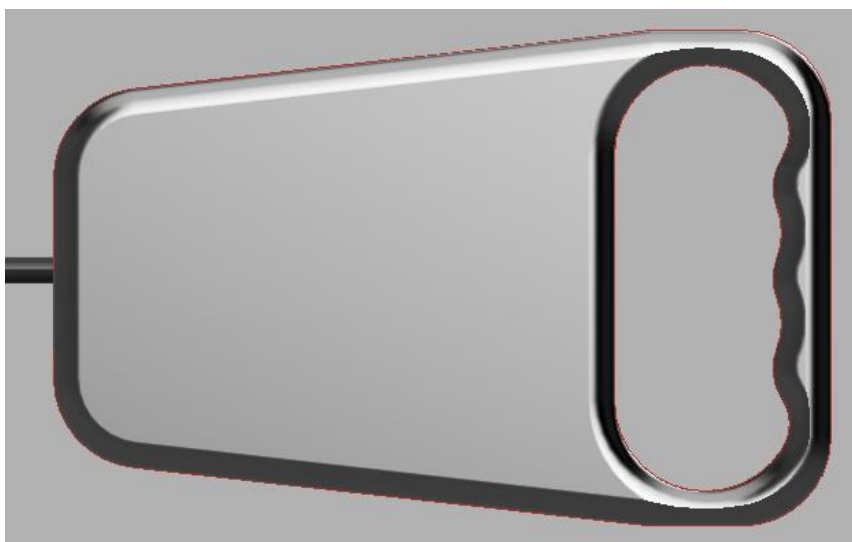

Rear View

OPTIONS

Body / Interleave Colours

Red, Yellow, Blue, Black, White and Grey subject to quantity.

Cable Termination / Connector

RJ45, Locking Circular, Bare-Wire

PROVISIONAL

Registered Design Pending